

October
2014



Welbeck Road Area Parking Review

STATUTORY CONSULTATION

IMPORTANT – THIS AFFECTS YOU – PLEASE READ

Welbeck Road Area Parking Review

What is this about?

Following a public consultation in your area, earlier this year, where residents were asked if they had parking problems in their road and if so how they would like it to be addressed, the Council is now proposing to put in place additional parking controls on roads near you. We also advised of proposals to place double yellow lines at junctions, crossing points and bends for safety and access reasons. This is your opportunity to comment on or object to our proposals.

The results of the public consultation were reported to local councillors and the Portfolio Holder for Environment, Crime and Community Safety in July 2014 and it was agreed to introduce a controlled parking zone (CPZ) in areas where majority support for parking controls was demonstrated.

In order to do this the council is now proceeding to the statutory consultation stage. This is the legal process that the council is required to undertake before any changes can be made to any waiting or loading restrictions, or before introducing parking bays / controls on the public highway.

A summary of the parking proposals are listed below and should be viewed in association with the enclosed plan. The proposals which will be advertised as part of the statutory consultation process include:

- A new controlled parking zone (CPZ) to operate between Monday to Saturday 8am to 6.30 in the following roads or parts of roads:
 - Welbeck Road – Coles Crescent to Twyford Road,
 - Tintern Way – Welbeck Road to no. 75 Tintern Way,
 - Drinkwater Road adjacent to Cerise Court,
 - Coles Crescent – Welbeck Road to no.83 Coles Crescent,
 - Eliot Road – adjacent to Annan Court, and
 - Scott Crescent
- At any time waiting restrictions (double yellow lines) at junctions / bends in Abercorn Crescent, Austen Road, Chatsworth Gardens, Coles Crescent, Drinkwater Road, Eliot Drive, Scott Crescent, Swift Close, Tintern Way, Twyford Road, and Welbeck Road for safety and access reasons in accordance with guidance in the Highway Code. A copy of the plan can also be viewed from 2nd October 2014 on the council website at: www.harlow.gov.uk/trafficorders

The council has also considered the issue of parking displacement to Scott Crescent, even though there was no majority support, because of its close proximity to Welbeck Road and The Arches. Therefore Scott Crescent will be included in the statutory consultation process to provide another opportunity for residents to consider whether they want to be in a CPZ because of the potential for parking displacement to this road.





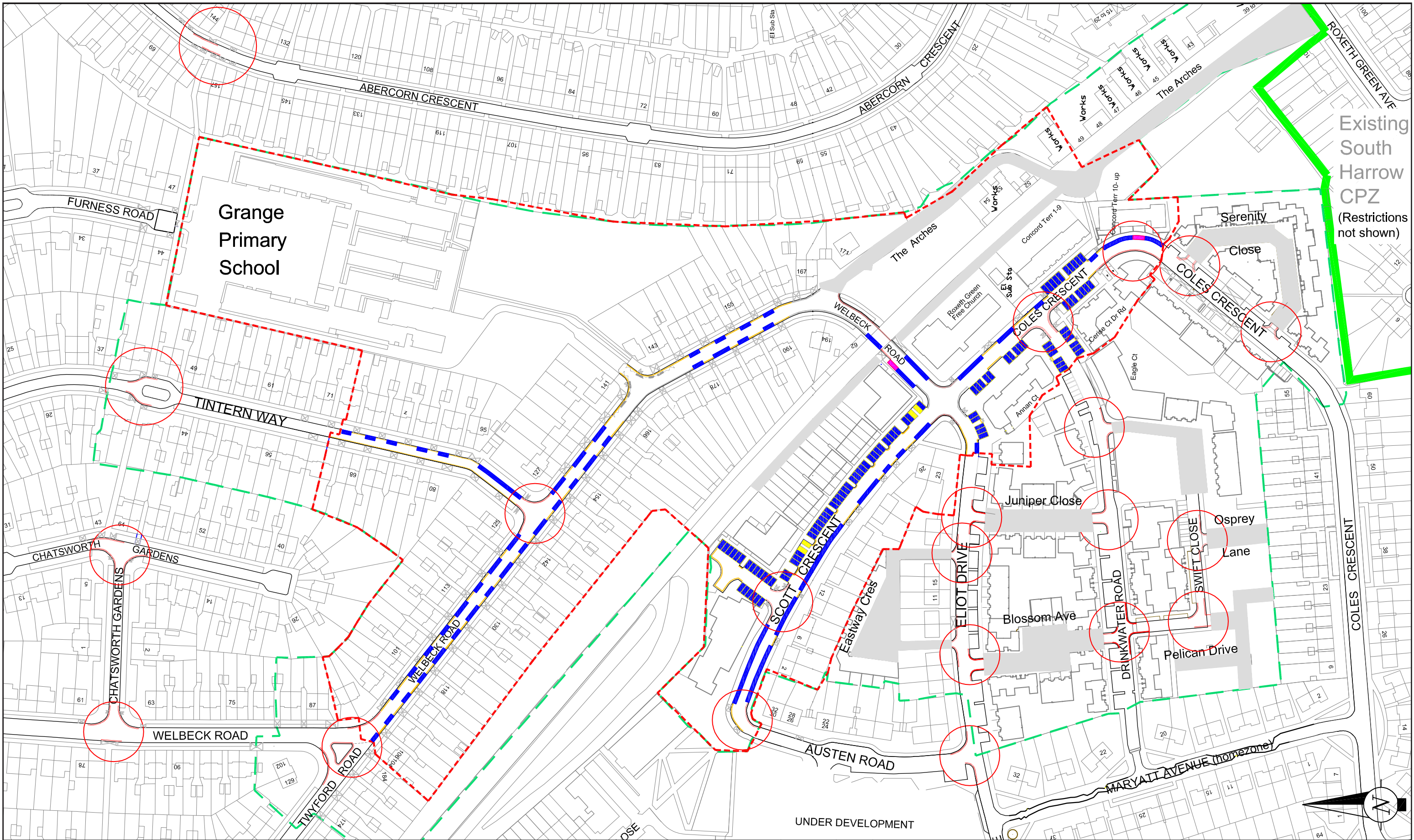

For information the report which includes all the consultation results and additional information can be viewed on the Harrow Council website at - <http://tinyurl.com/nr95vwb> . The link will need to be entered into your web browser. If you do not have personal access to the internet the council public libraries do have internet access that residents may use.

The cost of parking permits (per vehicle) for your information are as follows:

1st vehicle in household	£ 64.90	2nd vehicle	£ 97.30
3rd vehicle	£129.80	4th and subsequent vehicle	£162.20

Visitor permits are £16.20 per book of 10, which is reduced to £8.10 for senior citizens or those receiving mobility benefits if the discount is claimed. Blue badge displaying vehicles are free



- NOTES:**
-  Consultation area for original parking review & possible CPZ.
 -  Statutory consultation on controlled parking zone in this area
 -  Proposed CPZ bays and single zone time yellow lines
 -  Existing disabled bay and provisional disabled bay subject to confirmation
 -  Double yellow lines proposed at junctions, bends etc as part of statutory consultation
 -  Existing single and double yellow lines

Harrow COUNCIL
LONDON

ENVIRONMENT & ENTERPRISE
TRAFFIC & PARKING

P.O. Box 39, Civic Centre,
Harrow, Middlesex, HA1 2XA
Tel: 020 8863 5611
Fax: 020 8420 9611

Designation	Details of Revision	Date	Sign	Project
A	For consultation	14/02/14	SMF	WELBECK ROAD AREA PARKING REVIEW
B	For statutory consultation	01/09/14	SMF	

This map is reproduced from or based upon Ordnance Survey material with the permission of Ordnance Survey on behalf of the Controller of Her Majesty's Stationery Office (c) Crown copyright. Unauthorised reproduction infringes Crown Copyright and may lead to prosecution or civil proceedings. London Borough of Harrow 100019206.

Project
WELBECK ROAD AREA
PARKING REVIEW

Title
Statutory consultation for
proposed new Controlled Parking
Zone and Associated Restrictions

Scale NTS @ A3	Drawn SMF	Checked AL
Drawing no T/DWG/000652	Date 10/12/13	
Autocad file O:\TRAFFIC\Projects\TPR0122 Welbeck Road CPZ\Drawings\WelbeckCPZ stat consultationpublic_a.dwg		

What happens next?

We are now at the statutory consultation stage. This is the legal process that the council must carry out before any changes can be made to any waiting (or loading) restrictions, or designated parking bays on the public highway. We must consider all formal representations at this stage before a final decision is made as to which proposals are actually introduced and a Traffic Regulation Order (TRO) is made to enable the lines and signs on the street to be enforced.

This is your opportunity to review the plans and make any final comments that you have about the proposal or to make a formal representation/objection. It will not be possible to add to or increase the extent of the restrictions, as the scheme has been developed using previous resident and business comments. The scale of the proposals can however be reduced either in the area covered or in the time the restrictions apply. This does apply to all the proposed restrictions which could in theory be abandoned. However, the double yellow lines proposed for safety and access reasons are likely to proceed.

As part of statutory consultation we advertise the TRO by placing notices on street lamp columns and in a local paper on or about **2 October 2014** this will also explain where the plans can be seen.

We will report any comments or formal objections to the next available Traffic and Road Safety Advisory Panel meeting, which is expected to be on the 10th December 2014. This Panel will decide what changes should be made to the proposals to address your feedback, particularly any objections and approve a final scheme for a formal decision by the Portfolio Holder. Following this decision the scheme will be given to our contractors to implement and all residents will be informed of the outcome.

Making a formal statutory objection

During the statutory consultation process anyone can make a comment or formal statutory objection to the proposals. If you want to make a formal objection, this needs to be made **in writing (email is acceptable)** including the word **object** or **objection** (to distinguish it clearly from comments) and provide the **reason** or **basis** of the objection and how you would be **materially affected**. You also need to provide your name and full address. There is a set 3 week period in which any objections need to be made – please see the deadline below.

Please return your comments/objections to:

Service Manager -Traffic, Highway and Asset Management
Harrow Council
PO Box 39
Civic Centre
Harrow
HA1 2XA

or by email to: transportation@harrow.gov.uk

These need to be received by **22 October 2014** quoting ref **DP 2014- 13**.

More information

If you have any further questions, or wish to comment, please contact the project engineer:
Stephen Freeman – 020 8424 1437 Email: transportation@harrow.gov.uk

Please call the number below for a large print version of this document, or a summary of this document in your language.

- Albanian** Nëqoftëse gjuha Angleze nuk është gjuha juaj e parë, dhe keni nevojë për përkthimin e informatave të përmbajtura në këtë dokumentë, ju lutemi kontaktoni numërin dhënë.
- Arabic** اذا كانت الانجليزية ليست لغتك الاولى وتحتاج لترجمة معلومات هذه الوثيقة، الرجاء الاتصال على رقم
- Bengali** যদি ইংরেজি আপনার মাতৃভাষা না হয় এবং আপনি যদি এই প্রচারপত্রের তথ্যগুলোর অনুবাদ পেতে চান তাহলে যে টেলিফোন নম্বর দেওয়া আছে সেখানে দয়া করে যোগাযোগ করুন।
- Chinese** 如果你主要說用的語言不是英語而需要將這份文件的內容翻譯成中文，請打註明的電話號碼提出這個要求。
- Farsi** اگر انگلیسی زبان اول شما نیست و شما نیاز به ترجمه اطلاعات موجود در این مدرک را دارید، لطفاً با شماره داده شده تماس بگیرید.
- Gujarati** જો ઈંગ્લિશ તમારી પ્રથમ ભાષા ન હોય અને આ દસ્તાવેજમાં રહેલ માહિતીનો તરજૂમો (ટ્રાન્સલેશન) તમને જોઈતો હોય તો કૃપા કરી જણાવેલ નંબર ઉપર ફોન કરો
- Hindi** यदि आपको अंग्रेजी समझ नहीं आती और आपको इस दस्तावेज़ में दी गई जानकारी का अनुवाद हिन्दी में चाहिए तो कृपया दिए गए नंबर पर फोन करें।
- Punjabi** ਜੇ ਤੁਹਾਨੂੰ ਅੰਗਰੇਜ਼ੀ ਸਮਝ ਨਹੀਂ ਆਉਂਦੀ ਤੇ ਤੁਹਾਨੂੰ ਇਸ ਦਸਤਾਵੇਜ਼ ਵਿਚ ਦਿੱਤੀ ਗਈ ਜਾਣਕਾਰੀ ਦਾ ਤਰਜਮਾ ਪੰਜਾਬੀ ਵਿਚ ਚਾਹੀਦਾ ਹੈ ਤਾਂ ਕਿਰਪਾ ਕਰਕੇ ਦਿੱਤੇ ਗਏ ਨੰਬਰ ਤੇ ਫੋਨ ਕਰੋ।
- Somali** Haddii Ingiriisku uusan ahayn afkaaga koowaad aadna u baahan tahay turjumidda xog ku jirta dokumentigan fadlan la xiriir lambarka lagu siiyey.
- Tamil** ஆங்கிலம் உங்கள் தாய்மொழியாக இல்லாதிருந்து இப்பத்திரத்திலிருக்கும் தகவலின் மொழிபெயர்ப்பு உங்களுக்கு தேவையப்பட்டால் தயவுசெய்து தரப்பட்ட தொலைபேசி எண்ணில் தொடர்பு கொள்ளவும்.
- Urdu** اگر انگریزی آپ کی مادری زبان نہیں ہے اور آپ کو اس دستاویز میں دی گئی معلومات کا اردو ترجمہ درکار ہے، تو براہ کرم دئے گئے نمبر پر رابطہ کریں۔

020 8424 1437